

# WALKING FOOT

## TO ATTACH "WALKING FOOT" ON THE MACHINE

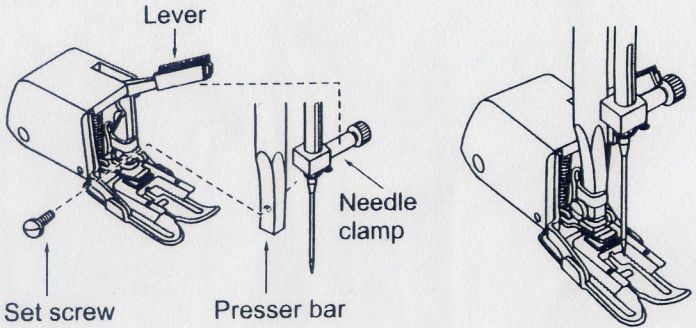

1. Raise the needle, and the presser foot.
  2. Loosen the set screw on the foot holder to remove it.
  3. Attach the walking foot to the presser bar with the lever on the needle clamp, and secure it with the set screw.
- \* Operate the machine at low to medium speed.
  - \* Set the stitch length in the range of 0-4.

The "walking foot" is a piece of equipment that helps fabric feed more smoothly.

With this foot, fabric can be sewn without shifting or puckering since the fabric is held and fed by both upper and lower feed dogs.

It works well with materials like lawn, knit, vinyl, or leather.